

RC3 Inspection camera - digital

for pipe inspection up to 15 m

Item no.: 10214

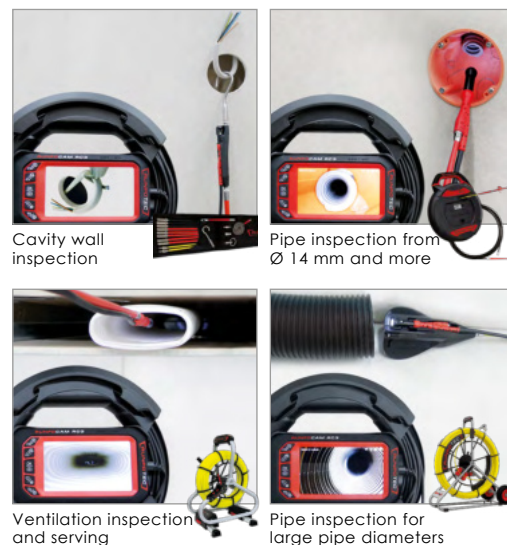

Examples of application with pulling systems

**DATA**

ITEM NO.:	10214
CABLE LENGTH	15 m
NET WEIGHT	1,336 kg
EAN-CODE	9120045477894
CAMERA REEL	Ø 260 mm x H 63 mm
MONITORMODUL	B 96 mm x L 172 mm x H 31 mm
CAMERA HEAD	Ø 13 mm - 998.400 pixels - Front and side camera
ILLUMINATION	Front: 8 x LED (integrated camera head) - dimmable Side: 1 x LED (integrated camera head) - dimmable
MONITOR	5" IPS (518.400 Pixel - 960 x 540) Color
ANGLE OF VIEW	70 °
PHOTO RESOLUTION	1920 x 1080 (JPG) Front and side camera
VIDEO RESOLUTION	1920 x 1080 (AVI) Front and side camera
FOCUS DISTANCE	Front: 30 mm – 80 mm / Seite: 20 mm – 40 mm
PROTECTION CLASS	IP 67 (camera head and cable)
BATTERY CAPACITY	3000 mAh Lithium-ion- battery (3 hours)
LANGUAGES	DE, EN, FR, ES, PT, NL, PL, CZ, HR
OPERATING SYSTEM	WLAN (Android 6.0+ / IOS 10.0+)

DESCRIPTION

The RC3 inspection camera (digital) combines innovative technology with smart connectivity to make professional inspections easier and more precise. Equipped with a flexible dual camera system, it delivers images and videos in full HD quality. The RC3 app enables the preservation of evidence, image archiving and comprehensive documentation of recordings, and it allows for easy sharing of images and videos. Reports with a company logo and description can be sent as a PDF via email or WhatsApp. The camera is perfect for use in areas that are difficult to access because it can be controlled via WLAN using the RC3 app on a smartphone. Whether it's hollow walls, pipes with an internal diameter of 14 mm or ventilation systems, the RC3 delivers razor-sharp images, can be conveniently operated via mobile devices and has an IP67 protection class. It should be noted that the camera can only be used in combination with the RUNPOTEC cable pulling systems (GF3, GF4.5, GF6, RUNPOSTICKS and RP1), with different systems being used depending on the application.

Scope of supply: 1 x RC3 inspection camera (box incl. monitor module, cable incl. camera head 15 m), 1 x RC2/RC3 thread attachment, attachment flexible, fiberglass rod Ø 3 mm - 1 m, micro memory card 8 GB, connection thread, magnet, fishing hook, USB charging cable 1.5 m (USB/USB-C plug)

ADVANTAGES

- Pipe inspections from Ø14 mm ID
- Inspection of ventilation pipes, drainage pipes, sewage pipes etc.
- For cavity inspections and suspended ceilings
- Camera head with front and side camera incl. 8 x LED lights - dimmable
- RC3 can be operated via WLAN and RC3 app (optional)
- Preservation of evidence, image archiving, documentation of recordings
- Protection class IP 67 (camera head and cable)
- Battery life 3 hours
- Box with rotating handle and grip
- Accessory box (8-parts)

INFORMATION**Combinable pulling systems:****RP1 cable pulling tape Ø 4 mm**

5 - 30 m - Item no.: 30027 - 30043

**GF3 Fiberglass rod Ø 3 mm**

with or without meter counter

20 - 50 m - Item no.: 10192 - 10195

20 - 50 m - Item no.: 10196 - 10198

**Fiberglass rod**

GF4.5, GF6

**RUNPOSTICKS**

Comfort - Item no.: 10020

Standard - Item no.: 10016

